

Luminaire Schedule						
Symbol	Qty	Label	Arrangement	LLF	Description	
	1	SA	SINGLE	1.000	OSQM-B-16L-40K7-3M-UL-NM / OSQ-BLSMF / OSQ-ML-B-AA	Arr. Watts 104
	4	SB	SINGLE	0.900	OSQM-B-16L-40K7-4M-UL-NM / OSQ-BLSMF / OSQ-ML-B-AA	Arr. Lum. Lumens 12349

Calculation Summary							
Label	Units	Avg	Max	Min	Avg/Min	Max/Min	Grid Z
Parking	Fc	2.88	8.7	1.1	2.62	7.91	0

**DRC**

PZ21-12000028  
10/20/2021

## OSQ Series

OSQ™ LED Area/Flood Luminaire featuring Cree TrueWhite® Technology – Medium & Large

Rev. Date: V4 04/14/2021

### Product Description

The OSQ™ Area/Flood luminaire blends extreme optical control, advanced thermal management and modern, clean aesthetics. Built to last, the housing is rugged cast aluminum with an integral, weatheright LED driver compartment. Versatile mounting configurations offer simple installation. Its slim, low-profile design minimizes wind load requirements and blends seamlessly into the site providing even, quality illumination. The 4L lumen package is a suitable upgrade for HID applications up to 250 Watt, and the 11L lumen package is a suitable upgrade for HID applications up to 400 Watt. The 22L lumen package is a suitable upgrade for HID applications up to 750 Watts, and the 30L lumen package is a suitable upgrade for HID applications up to 1000 Watts.

**Applications:** Parking lots, walkways, campuses, car dealerships, office complexes, tunnels, underpasses, and internal roadways

### Performance Summary

Utilizes Cree TrueWhite® Technology on 5000K Luminaires

NanoOptic® Precision Delivery Grid™ optic

Assembled in the U.S.A. of U.S. and imported parts

**Initial Delivered Lumens:** 4,000 - 30,000

**Efficacy:** Up to 173 LPW

**CRI:** Minimum 70 CRI (3000K, 4000K & 5700K); 90 CRI (5000K)

**CCT:** 3000K, 4000K, 5000K, 5700K

**Limited Warranty:** 10 years on luminaire; 10 years on Colorfast DeltaGuard® finish; up to 5 years for Synapse® accessories; 1 year on luminaire accessories

\*See <http://creelighting.com/warranty> for warranty terms. For Synapse accessories, consult Synapse spec sheets for details on warranty terms.

### Ordering Information

Fully assembled luminaire is composed of two components that must be ordered separately:

Example: **Mount:** OSQ-ML-B-AA-BK + **Luminaire:** OSQM-B-4L-30K7-2M-UL-NM-BK

Mount (Luminaire must be ordered separately)*	
OSQ-	
OSQ-ML-B-AA Adjustable Arm	Color Options: SV Silver BK Black BZ Bronze WH White
OSQ-ML-B-DA Direct Arm	
OSQ-ML-B-TSP Transportation Mount (stainless steel; do not specify color)	
OSQ-ML-B-TM Trunnion Mount	

\*Reference EPR and pole configuration suitability data beginning on page 10

Luminaire (Mount must be ordered separately)									
OSQ	Family	Size	B	Lumen Package	CCT/CRI	Optic	Voltage	Mount	Color Options



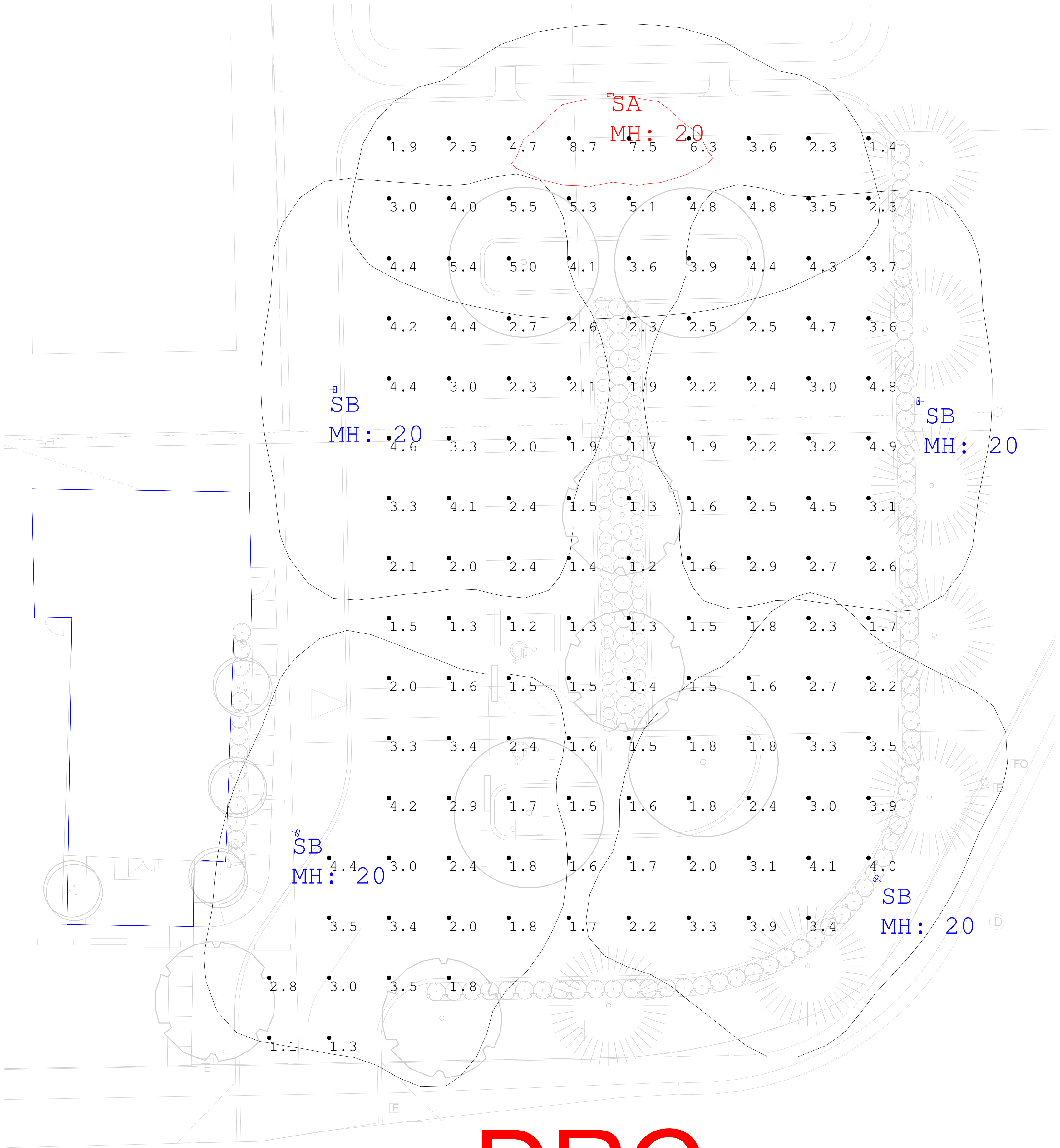

Scale: 1 inch= 10 Ft.

**DRC**

PZ21-12000028  
10/20/2021

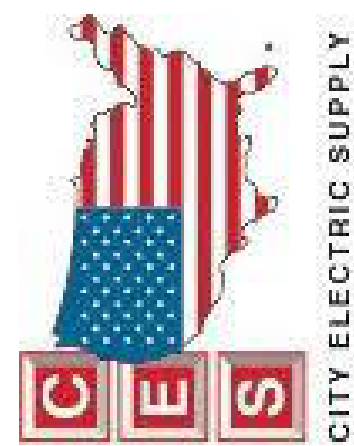

Revisions				
#	Date	Comments		

Drawn By: JS	Checked By:	Date: 7/5/2021	Scale: 1" = 10'

St. Phillip Church	Parking Lot